

ADULT HARD-SHELL SEA TURTLE TAG SUITE SPECIFICATIONS

PG 1 OF 2

Model	Argos	Fastloc®	Depth	Temperature	Light Level	Life (days) ¹	L x W x H (mm) ²	Weight (g)
SPOT-352	✓			✓		920	72 x 56 x 22	129
SPOT-375	✓			✓		920	99 x 55 x 21	136
SPLASH10-334	✓		✓	✓	Optional	1080	112 x 63 x 62	450
SPLASH10-BF-334	✓	✓		✓	Optional	1010	112 x 63 x 62	450
SPLASH10-F-334	✓	✓	✓	✓	Optional	1010	112 x 63 x 62	450

1) The above estimated lives are calculated assuming 250 transmissions and 24 Fastloc® attempts per day. Utilizing the Wet/Dry sensor and duty cycling, the life can be extended.

2) Height is measured from tag bottom to top surface of the tag body, excluding the additional abrasion-resisitant epoxy protection.

Sea turtle tags are available with stainless steel or copper wet/dry washers.

Model: SPOT-352

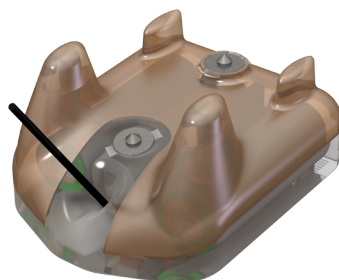

Model: SPOT-375

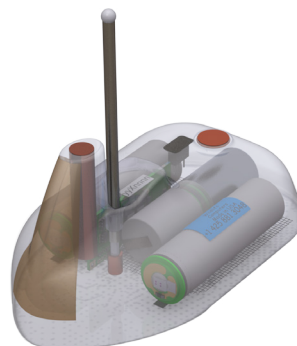

Model: SPLASH10-F-334



ADULT HARD-SHELL SEA TURTLE TAG SUITE SPECIFICATIONS

PG 2 OF 2

Model	Argos	Fastloc®	Depth	Temperature	Light Level	Life (days) ¹	L x W x H (mm) ²	Weight (g)
SPLASH10-351	✓		✓	✓	Optional	260	86 x 55 x 25	149
SPLASH10-BF-351	✓	✓		✓	Optional	240	86 x 55 x 25	149
SPLASH10-F-351	✓	✓	✓	✓	Optional	240	86 x 55 x 25	149
SPLASH10-344	✓		✓	✓	Optional	510	86 x 85 x 25	215
SPLASH10-BF-344	✓	✓		✓	Optional	470	86 x 85 x 25	215
SPLASH10-F-344	✓	✓	✓	✓	Optional	470	86 x 85 x 25	215

1) The above estimated lives are calculated assuming 250 transmissions and 24 Fastloc® attempts per day. Utilizing the Wet/Dry sensor and duty cycling, the life can be extended.

2) Height is measured from tag bottom to top surface of the tag body, excluding the additional abrasion-resisitant epoxy protection.

Sea turtle tags are available with stainless steel or copper wet/dry washers.

Model: SPLASH10-F-351



Model: SPLASH10-F-344

