

Model	Argos	Fastloc [®]	Depth	Temperature	Light Level	Life (days) ¹	L x W x H (mm) ²	Weight (g)
SPOT-352	✓			✓		920	72 x 56 x 22	129
SPOT-375	✓			✓		920	99 x 55 x 21	152
SPLASH10-334	✓		✓	✓	Optional	1080	112 x 63 x 62	450
SPLASH10-BF-334	✓	✓		✓	Optional	1010	112 x 63 x 62	450
SPLASH10-F-334	✓	✓	✓	✓	Optional	1010	112 x 63 x 62	450

1) The above estimated lives are calculated assuming 250 transmissions and 24 Fastloc[®] attempts per day. Utilizing the Wet/Dry sensor and duty cycling, the life can be extended.

2) Height is measured from tag bottom to top surface of the tag body, excluding the additional abrasion-resistant epoxy protection.

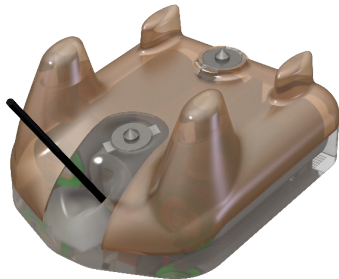

Model: SPOT-352

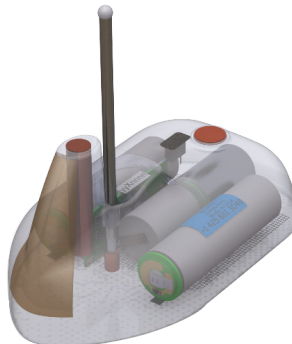

Model: SPOT-375



Model: SPLASH10-F-334/
BF-334/ 10-334 /

tags@wildlifecomputers.com
WildlifeComputers.com
+1 (425) 881-3048

8310 154th Ave NE, Suite 150
Redmond, WA, 98052 USA

v.18-06 7.1

This is a small representation of our available tags. Tag features and specifications subject to change without notice. Comparative scale is approximate. Argos antennas not shown to length. © Wildlife Computers. All rights reserved.

To Learn More Call: +1 (425) 881-3048 or Email: tags@wildlifecomputers.com

Model	Argos	Fastloc [®]	Depth	Temperature	Light Level	Life (days) ¹	L x W x H (mm) ²	Weight (g)
SPLASH10-351	✓		✓	✓	Optional	260	86 x 55 x 25	149
SPLASH10-BF-351	✓	✓		✓	Optional	240	86 x 55 x 25	149
SPLASH10-F-351	✓	✓	✓	✓	Optional	240	86 x 55 x 25	149
SPLASH10-344	✓		✓	✓	Optional	510	86 x 85 x 25	215
SPLASH10-BF-344	✓	✓		✓	Optional	470	86 x 85 x 25	215
SPLASH10-F-344	✓	✓	✓	✓	Optional	470	86 x 85 x 25	215
SPLASH10-BF-385	✓	✓		✓	Optional	510	120 x 66 x 50	290
SPLASH10-F-385	✓	✓	✓	✓	Optional	510	120 x 66 x 50	290

1) The above estimated lives are calculated assuming 250 transmissions and 24 Fastloc[®] attempts per day. Utilizing the Wet/Dry sensor and duty cycling, the life can be extended.

2) Height is measured from tag bottom to top surface of the tag body, excluding the additional abrasion-resistant epoxy protection.

Model: SPLASH10-F-351/ BF-351/ 10-351



Model: SPLASH10-F-344/ BF-244/ 10-344



Model: SPLASH10-F-385/ BF-385



tags@wildlifecomputers.com
WildlifeComputers.com
+1 (425) 881-3048

8310 154th Ave NE, Suite 150
Redmond, WA, 98052 USA

v.18-06 7.1

This is a small representation of our available tags. Tag features and specifications subject to change without notice. Comparative scale is approximate. Argos antennas not shown to length. © Wildlife Computers. All rights reserved.

To Learn More Call: +1 (425) 881-3048 or Email: tags@wildlifecomputers.com